





# THE ARBORS AT DOGWOOD CREEK SECTION 1



NOTE:  
EXCEPT AS NOTED, ALL ROWS HAVE A 60' ROW.  
ALL OUT-DEDS HAVE A 60' ROW.  
IN ADDITION TO ANY EASEMENTS SHOWN, A  
UNIDY EASEMENT OF 15' ALONG ALL LOT LINES  
IN THIS SUBDIVISION, IS HEREBY DEDICATED.  
NO BUILDING OR STRUCTURE SHALL BE LOCATED ON ANY LOT  
NEARER THAN TEN FEET (10') TO AN INTERIOR BOUNDARY LINE OR  
FEET (25') TO THE FRONT OR REAR LOT LINES.  
NO LOTS IN THIS SUBDIVISION SHALL FRONT ON DOGWOOD DRIVE  
OR STATE HIGHWAY 95.  
LOTS 55 AND 40 FRONT ON SPANISH OAK THAT  
LIES 55 AND 40 FEET FROM THE FRONT OF THE  
LOTS 52 AND 47 FRONT ON ARBORS DRIVE  
OR STATE HIGHWAY 95.  
NO STRUCTURES SHALL FACE DOGWOOD DRIVE OR STATE HIGHWAY  
95, AND NO DRIVEWAYS ARE PERMITTED TO ACCESS DOGWOOD DRIVE  
OR STATE HIGHWAY 95.

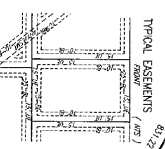

STATE OF TEXAS  
COUNTY OF BASTROP

I, Paul L. Moore, do hereby certify that I prepared this plat from an original and  
correct survey made under my personal supervision and that the same  
were properly placed under my personal signature and seal in accordance with the  
Regulations of Bastrop County, Louisiana.

Paul L. Moore, Surveyor  
Bastrop, Louisiana 70022  
(504) 337-5476

STATE OF TEXAS  
COUNTY OF BASTROP

I, Ronald D. Moore, do hereby certify that this subdivision meets  
the Subdivision Regulations for Bastrop County.

Ronald D. Moore, Surveyor  
Bastrop, Louisiana 70022  
(504) 337-5476

**DRYNESS CLASIFICATION TABLE**

LOT#	UNSAT	UNSAT	UNSAT
1	1	1	1
2	1	1	1
3	1	1	1
4	1	1	1
5	1	1	1
6	1	1	1
7	1	1	1
8	1	1	1
9	1	1	1
10	1	1	1
11	1	1	1
12	1	1	1
13	1	1	1
14	1	1	1
15	1	1	1
16	1	1	1
17	1	1	1
18	1	1	1
19	1	1	1
20	1	1	1
21	1	1	1
22	1	1	1
23	1	1	1
24	1	1	1
25	1	1	1
26	1	1	1
27	1	1	1
28	1	1	1
29	1	1	1
30	1	1	1
31	1	1	1
32	1	1	1
33	1	1	1
34	1	1	1
35	1	1	1
36	1	1	1
37	1	1	1
38	1	1	1
39	1	1	1
40	1	1	1
41	1	1	1
42	1	1	1
43	1	1	1
44	1	1	1
45	1	1	1
46	1	1	1
47	1	1	1
48	1	1	1
49	1	1	1
50	1	1	1
51	1	1	1
52	1	1	1
53	1	1	1
54	1	1	1
55	1	1	1
56	1	1	1
57	1	1	1
58	1	1	1
59	1	1	1
60	1	1	1
61	1	1	1
62	1	1	1
63	1	1	1
64	1	1	1
65	1	1	1
66	1	1	1
67	1	1	1
68	1	1	1
69	1	1	1
70	1	1	1
71	1	1	1
72	1	1	1
73	1	1	1
74	1	1	1
75	1	1	1
76	1	1	1
77	1	1	1
78	1	1	1
79	1	1	1
80	1	1	1
81	1	1	1
82	1	1	1
83	1	1	1
84	1	1	1
85	1	1	1
86	1	1	1
87	1	1	1
88	1	1	1
89	1	1	1
90	1	1	1
91	1	1	1
92	1	1	1
93	1	1	1
94	1	1	1
95	1	1	1
96	1	1	1
97	1	1	1
98	1	1	1
99	1	1	1
100	1	1	1

MANUAL FINISHED FLOOR ELEVATIONS  
SHOWING THE Minimum Finished Floor Elevation  
of Any Structure to be placed at any location  
on this plat, as indicated by ...

CLIMATE DATA

1	1	1	1
2	1	1	1
3	1	1	1
4	1	1	1
5	1	1	1
6	1	1	1
7	1	1	1
8	1	1	1
9	1	1	1
10	1	1	1
11	1	1	1
12	1	1	1
13	1	1	1
14	1	1	1
15	1	1	1
16	1	1	1
17	1	1	1
18	1	1	1
19	1	1	1
20	1	1	1
21	1	1	1
22	1	1	1
23	1	1	1
24	1	1	1
25	1	1	1
26	1	1	1
27	1	1	1
28	1	1	1
29	1	1	1
30	1	1	1
31	1	1	1
32	1	1	1
33	1	1	1
34	1	1	1
35	1	1	1
36	1	1	1
37	1	1	1
38	1	1	1
39	1	1	1
40	1	1	1
41	1	1	1
42	1	1	1
43	1	1	1
44	1	1	1
45	1	1	1
46	1	1	1
47	1	1	1
48	1	1	1
49	1	1	1
50	1	1	1
51	1	1	1
52	1	1	1
53	1	1	1
54	1	1	1
55	1	1	1
56	1	1	1
57	1	1	1
58	1	1	1
59	1	1	1
60	1	1	1
61	1	1	1
62	1	1	1
63	1	1	1
64	1	1	1
65	1	1	1
66	1	1	1
67	1	1	1
68	1	1	1
69	1	1	1
70	1	1	1
71	1	1	1
72	1	1	1
73	1	1	1
74	1	1	1
75	1	1	1
76	1	1	1
77	1	1	1
78	1	1	1
79	1	1	1
80	1	1	1
81	1	1	1
82	1	1	1
83	1	1	1
84	1	1	1
85	1	1	1
86	1	1	1
87	1	1	1
88	1	1	1
89	1	1	1
90	1	1	1
91	1	1	1
92	1	1	1
93	1	1	1
94	1	1	1
95	1	1	1
96	1	1	1
97	1	1	1
98	1	1	1
99	1	1	1
100	1	1	1

